



OAKLAND CIVIC

THE REDEVELOPMENT OF 10 10th ST
THE FORMER HENRY J. KAISER CONVENTION CENTER & CALVIN SIMMONS THEATRE

SPUR
July 10, 2019



AUDITORIUM OF THE CITY OF OAKLAND DEDICATED BY THE CITIZENS TO THE INTELLECTUAL AND INDUSTRIAL PROGRESS OF THE PEOPLE ANNO DOMINI MCMXIV



COURT HOUSE

12TH STREET

AMPHITHEATER

LAKE MERRITT BLVD

PERALTA
PARK

CIVIC ARENA

10TH STREET

LANEY COLLEGE



Enhanced 10th Street Frontage



Events Plan (Proposed)

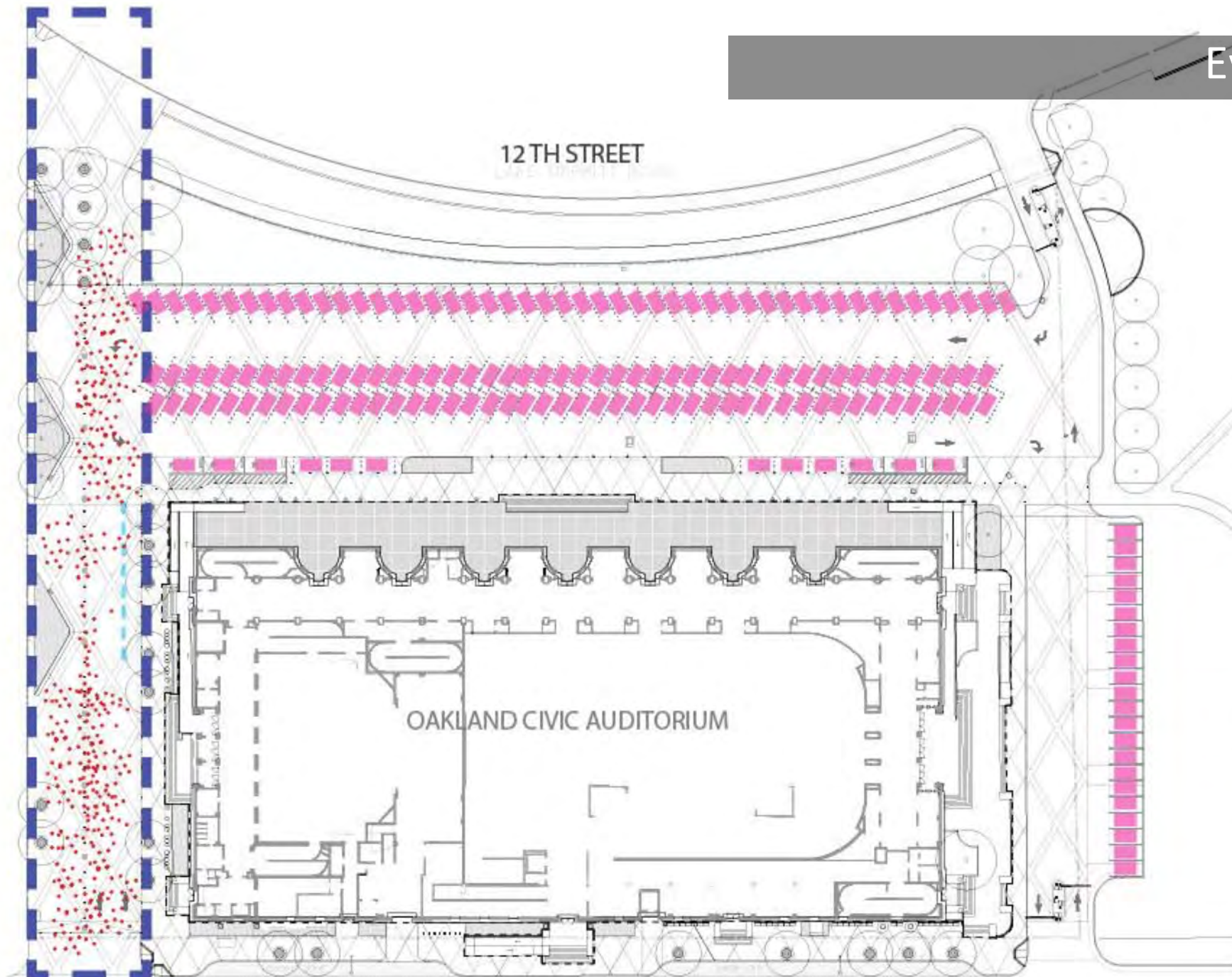

View of the Lake Along Lake Merritt Way



Pedestrian Walkway Toward Estuary Adjacent to Art Terrace





View of & Access to Art Niches from New Pedestrian Walkway Bordering Parking Lot

CS THEATER: First Floor Plan

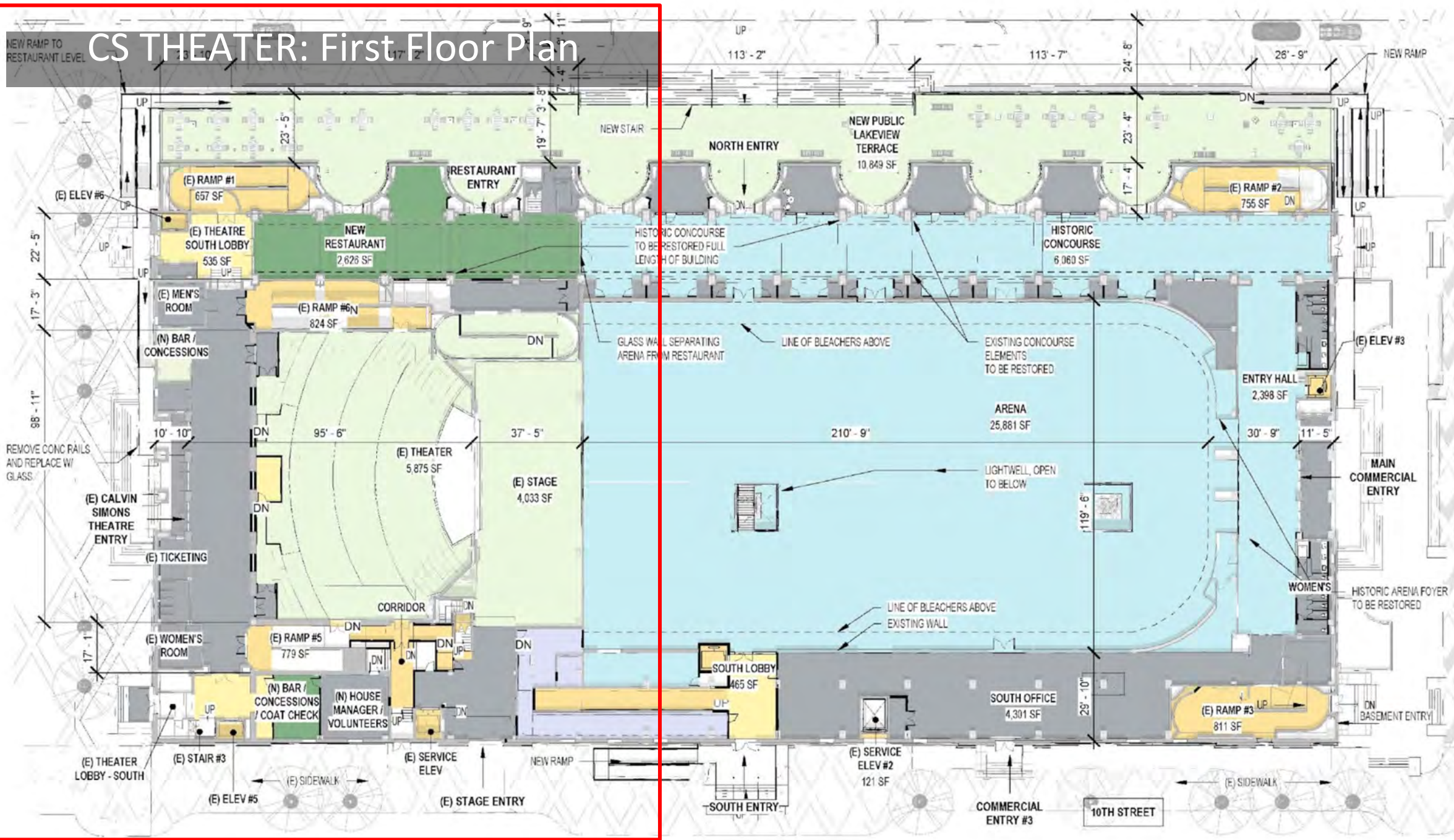

Mason's Meeting 1950's



Calvin Simmons Theatre



Calvin Simmons Theatre



CS Theater Ball Room – Event Space



CS Theater Gold Room – Rehearsal Space



FORMER ARENA: First Floor Plan

This architectural floor plan illustrates the layout of the first floor of a former arena. The plan is divided into several functional zones:

- Central Arena:** A large, light blue rectangular area measuring 210'-9" by 119'-6". It features a "GLASS WALL SEPARATING ARENA FROM RESTAURANT" and "EXISTING CONCOURSE ELEMENTS TO BE RESTORED". Bleachers are indicated by dashed lines above the arena.
- Theater Area:** Located on the left side, featuring a large green "THEATER" (5,875 SF) and a green "NEW RESTAURANT" (2,626 SF). The theater includes a stage (4,033 SF) and a south lobby (465 SF). A "NEW STAIR" is located near the top center.
- Restaurant and Concessions:** The new restaurant is situated between the theater and the arena. It includes a "NEW PUBLIC LAKEVIEW TERRACE" (10,849 SF) and a "HISTORIC CONCOURSE" (6,060 SF) to be restored. A "GLASS WALL SEPARATING ARENA FROM RESTAURANT" is shown. A "NEW RAMP TO RESTAURANT LEVEL" is located at the top left.
- Support Spaces:** Various rooms are distributed throughout the plan, including:
 - (E) RAMP #1 (657 SF), (E) RAMP #2 (755 SF), (E) RAMP #3 (811 SF), (E) RAMP #4 (824 SF), (E) RAMP #5 (779 SF), and (E) RAMP #6 (824 SF).
 - (E) THEATRE SOUTH LOBBY (535 SF), (E) MEN'S ROOM, (E) WOMEN'S ROOM, (E) TICKETING, (E) CALVIN SIMONS THEATRE ENTRY, (E) WOMEN'S ROOM, (E) BAR / CONCESSIONS, (N) HOUSE MANAGER / VOLUNTEERS, (E) SERVICE ELEV, (E) STAIR #3, (E) STAIR #4, (E) STAIR #5, (E) STAIR #6, (E) STAIR #7, (E) STAIR #8, (E) STAIR #9, (E) STAIR #10, (E) STAIR #11, (E) STAIR #12, (E) STAIR #13, (E) STAIR #14, (E) STAIR #15, (E) STAIR #16, (E) STAIR #17, (E) STAIR #18, (E) STAIR #19, (E) STAIR #20, (E) STAIR #21, (E) STAIR #22, (E) STAIR #23, (E) STAIR #24, (E) STAIR #25, (E) STAIR #26, (E) STAIR #27, (E) STAIR #28, (E) STAIR #29, (E) STAIR #30, (E) STAIR #31, (E) STAIR #32, (E) STAIR #33, (E) STAIR #34, (E) STAIR #35, (E) STAIR #36, (E) STAIR #37, (E) STAIR #38, (E) STAIR #39, (E) STAIR #40, (E) STAIR #41, (E) STAIR #42, (E) STAIR #43, (E) STAIR #44, (E) STAIR #45, (E) STAIR #46, (E) STAIR #47, (E) STAIR #48, (E) STAIR #49, (E) STAIR #50, (E) STAIR #51, (E) STAIR #52, (E) STAIR #53, (E) STAIR #54, (E) STAIR #55, (E) STAIR #56, (E) STAIR #57, (E) STAIR #58, (E) STAIR #59, (E) STAIR #60, (E) STAIR #61, (E) STAIR #62, (E) STAIR #63, (E) STAIR #64, (E) STAIR #65, (E) STAIR #66, (E) STAIR #67, (E) STAIR #68, (E) STAIR #69, (E) STAIR #70, (E) STAIR #71, (E) STAIR #72, (E) STAIR #73, (E) STAIR #74, (E) STAIR #75, (E) STAIR #76, (E) STAIR #77, (E) STAIR #78, (E) STAIR #79, (E) STAIR #80, (E) STAIR #81, (E) STAIR #82, (E) STAIR #83, (E) STAIR #84, (E) STAIR #85, (E) STAIR #86, (E) STAIR #87, (E) STAIR #88, (E) STAIR #89, (E) STAIR #90, (E) STAIR #91, (E) STAIR #92, (E) STAIR #93, (E) STAIR #94, (E) STAIR #95, (E) STAIR #96, (E) STAIR #97, (E) STAIR #98, (E) STAIR #99, (E) STAIR #100, (E) STAIR #101, (E) STAIR #102, (E) STAIR #103, (E) STAIR #104, (E) STAIR #105, (E) STAIR #106, (E) STAIR #107, (E) STAIR #108, (E) STAIR #109, (E) STAIR #110, (E) STAIR #111, (E) STAIR #112, (E) STAIR #113, (E) STAIR #114, (E) STAIR #115, (E) STAIR #116, (E) STAIR #117, (E) STAIR #118, (E) STAIR #119, (E) STAIR #120, (E) STAIR #121, (E) STAIR #122, (E) STAIR #123, (E) STAIR #124, (E) STAIR #125, (E) STAIR #126, (E) STAIR #127, (E) STAIR #128, (E) STAIR #129, (E) STAIR #130, (E) STAIR #131, (E) STAIR #132, (E) STAIR #133, (E) STAIR #134, (E) STAIR #135, (E) STAIR #136, (E) STAIR #137, (E) STAIR #138, (E) STAIR #139, (E) STAIR #140, (E) STAIR #141, (E) STAIR #142, (E) STAIR #143, (E) STAIR #144, (E) STAIR #145, (E) STAIR #146, (E) STAIR #147, (E) STAIR #148, (E) STAIR #149, (E) STAIR #150, (E) STAIR #151, (E) STAIR #152, (E) STAIR #153, (E) STAIR #154, (E) STAIR #155, (E) STAIR #156, (E) STAIR #157, (E) STAIR #158, (E) STAIR #159, (E) STAIR #160, (E) STAIR #161, (E) STAIR #162, (E) STAIR #163, (E) STAIR #164, (E) STAIR #165, (E) STAIR #166, (E) STAIR #167, (E) STAIR #168, (E) STAIR #169, (E) STAIR #170, (E) STAIR #171, (E) STAIR #172, (E) STAIR #173, (E) STAIR #174, (E) STAIR #175, (E) STAIR #176, (E) STAIR #177, (E) STAIR #178, (E) STAIR #179, (E) STAIR #180, (E) STAIR #181, (E) STAIR #182, (E) STAIR #183, (E) STAIR #184, (E) STAIR #185, (E) STAIR #186, (E) STAIR #187, (E) STAIR #188, (E) STAIR #189, (E) STAIR #190, (E) STAIR #191, (E) STAIR #192, (E) STAIR #193, (E) STAIR #194, (E) STAIR #195, (E) STAIR #196, (E) STAIR #197, (E) STAIR #198, (E) STAIR #199, (E) STAIR #200, (E) STAIR #201, (E) STAIR #202, (E) STAIR #203, (E) STAIR #204, (E) STAIR #205, (E) STAIR #206, (E) STAIR #207, (E) STAIR #208, (E) STAIR #209, (E) STAIR #210, (E) STAIR #211, (E) STAIR #212, (E) STAIR #213, (E) STAIR #214, (E) STAIR #215, (E) STAIR #216, (E) STAIR #217, (E) STAIR #218, (E) STAIR #219, (E) STAIR #220, (E) STAIR #221, (E) STAIR #222, (E) STAIR #223, (E) STAIR #224, (E) STAIR #225, (E) STAIR #226, (E) STAIR #227, (E) STAIR #228, (E) STAIR #229, (E) STAIR #230, (E) STAIR #231, (E) STAIR #232, (E) STAIR #233, (E) STAIR #234, (E) STAIR #235, (E) STAIR #236, (E) STAIR #237, (E) STAIR #238, (E) STAIR #239, (E) STAIR #240, (E) STAIR #241, (E) STAIR #242, (E) STAIR #243, (E) STAIR #244, (E) STAIR #245, (E) STAIR #246, (E) STAIR #247, (E) STAIR #248, (E) STAIR #249, (E) STAIR #250, (E) STAIR #251, (E) STAIR #252, (E) STAIR #253, (E) STAIR #254, (E) STAIR #255, (E) STAIR #256, (E) STAIR #257, (E) STAIR #258, (E) STAIR #259, (E) STAIR #260, (E) STAIR #261, (E) STAIR #262, (E) STAIR #263, (E) STAIR #264, (E) STAIR #265, (E) STAIR #266, (E) STAIR #267, (E) STAIR #268, (E) STAIR #269, (E) STAIR #270, (E) STAIR #271, (E) STAIR #272, (E) STAIR #273, (E) STAIR #274, (E) STAIR #275, (E) STAIR #276, (E) STAIR #277, (E) STAIR #278, (E) STAIR #279, (E) STAIR #280, (E) STAIR #281, (E) STAIR #282, (E) STAIR #283, (E) STAIR #284, (E) STAIR #285, (E) STAIR #286, (E) STAIR #287, (E) STAIR #288, (E) STAIR #289, (E) STAIR #290, (E) STAIR #291, (E) STAIR #292, (E) STAIR #293, (E) STAIR #294, (E) STAIR #295, (E) STAIR #296, (E) STAIR #297, (E) STAIR #298, (E) STAIR #299, (E) STAIR #300, (E) STAIR #301, (E) STAIR #302, (E) STAIR #303, (E) STAIR #304, (E) STAIR #305, (E) STAIR #306, (E) STAIR #307, (E) STAIR #308, (E) STAIR #309, (E) STAIR #310, (E) STAIR #311, (E) STAIR #312, (E) STAIR #313, (E) STAIR #314, (E) STAIR #315, (E) STAIR #316, (E) STAIR #317, (E) STAIR #318, (E) STAIR #319, (E) STAIR #320, (E) STAIR #321, (E) STAIR #322, (E) STAIR #323, (E) STAIR #324, (E) STAIR #325, (E) STAIR #326, (E) STAIR #327, (E) STAIR #328, (E) STAIR #329, (E) STAIR #330, (E) STAIR #331, (E) STAIR #332, (E) STAIR #333, (E) STAIR #334, (E) STAIR #335, (E) STAIR #336, (E) STAIR #337, (E) STAIR #338, (E) STAIR #339, (E) STAIR #340, (E) STAIR #341, (E) STAIR #342, (E) STAIR #343, (E) STAIR #344, (E) STAIR #345, (E) STAIR #346, (E) STAIR #347, (E) STAIR #348, (E) STAIR #349, (E) STAIR #350, (E) STAIR #351, (E) STAIR #352, (E) STAIR #353, (E) STAIR #354, (E) STAIR #355, (E) STAIR #356, (E) STAIR #357, (E) STAIR #358, (E) STAIR #359, (E) STAIR #360, (E) STAIR #361, (E) STAIR #362, (E) STAIR #363, (E) STAIR #364, (E) STAIR #365, (E) STAIR #366, (E) STAIR #367, (E

Arts & Non-profit Offices



