



PUBLIC ARCHITECTURE



COMMIT

ACT

SHARE



STRENGTHENING NONPROFITS THROUGH DESIGN

JOIN THE 1%

MY 1% LOGIN

[About >>](#)

[Architect >>](#)

[Nonprofit >>](#)

[Manufacturer >>](#)

[Signup](#)

[Overview](#)

[User's Guide](#)

[Project Gallery](#)

[Participants](#)

[Supporters](#)

[News](#)

[Contact](#)



Flashmaps

274,142

Pro bono hours pledged annually >>

803

Architecture and design firms

Firms



>>

383

Nonprofits requesting assistance

Nonprofits



>>

[See all participants >>](#)

EMAIL PAGE

MAY WE HAVE A MOMENT OF YOUR TIME?



1% OF YOUR TIME TO BE EXACT

YOU COULD HAVE BEEN ANYTHING

An aerial photograph of a dense urban landscape, likely Tokyo, viewed from a high vantage point. The city is covered in a semi-transparent green filter. On the right side, a portion of a modern skyscraper with a grid-like facade is visible. The sky is filled with soft, white clouds.

YOU CHOSE TO BE A DESIGNER

WHY?

A photograph of two surgeons in an operating room, overlaid with a green tint. The text "DOCTORS SAVE LIVES" is centered in white. The surgeon in the foreground is wearing a blue surgical cap and mask, looking slightly to the side. The surgeon in the background is also wearing a blue surgical cap and mask, looking down. The background shows a white wall with a window and a surgical light fixture.

DOCTORS SAVE LIVES

DESIGNERS_____.

The image is a full-page photograph with a strong green color cast. It depicts a city skyline in the background, with several tall buildings visible against a bright, hazy sky. In the foreground, a large, flat, open area is filled with many people, appearing as small silhouettes. They are walking or standing, suggesting a public space like a park or a wide plaza. The overall mood is serene yet vibrant due to the monochromatic green tint.

**QUALITY OF LIFE IS RELATED TO
QUALITY OF SPACE**

**QUALITY OF SPACE IS AVAILABLE
TO THOSE WHO HAVE:**

- A) MONEY**
- B) NEED**

A photograph of a coffee machine with a glass carafe, overlaid with a green tint and the text "1% OF AN 8 HOUR DAY IS 4.8 MINUTES". The coffee machine is white with a glass carafe and a control panel with four buttons. The background is a light-colored wall. The text is in a bold, white, sans-serif font, centered horizontally and slightly above the middle vertically.

1% OF AN 8 HOUR DAY IS 4.8 MINUTES

1,000,000

DESIGN PROFESSIONALS

20,000,000

HOURS ANNUALLY

10,000

**PERSON FIRM WORKING
FULL-TIME FOR A YEAR**

WHAT CAN YOU DO WITH 1%?

THE POWER OF

PRO BONO

**40 Stories about Design for
the Public Good by Architects
and Their Clients**

Edited by John Cary and Public Architecture



Distributed by D.A.P.
www.ARTBOOK.com

Project Locations

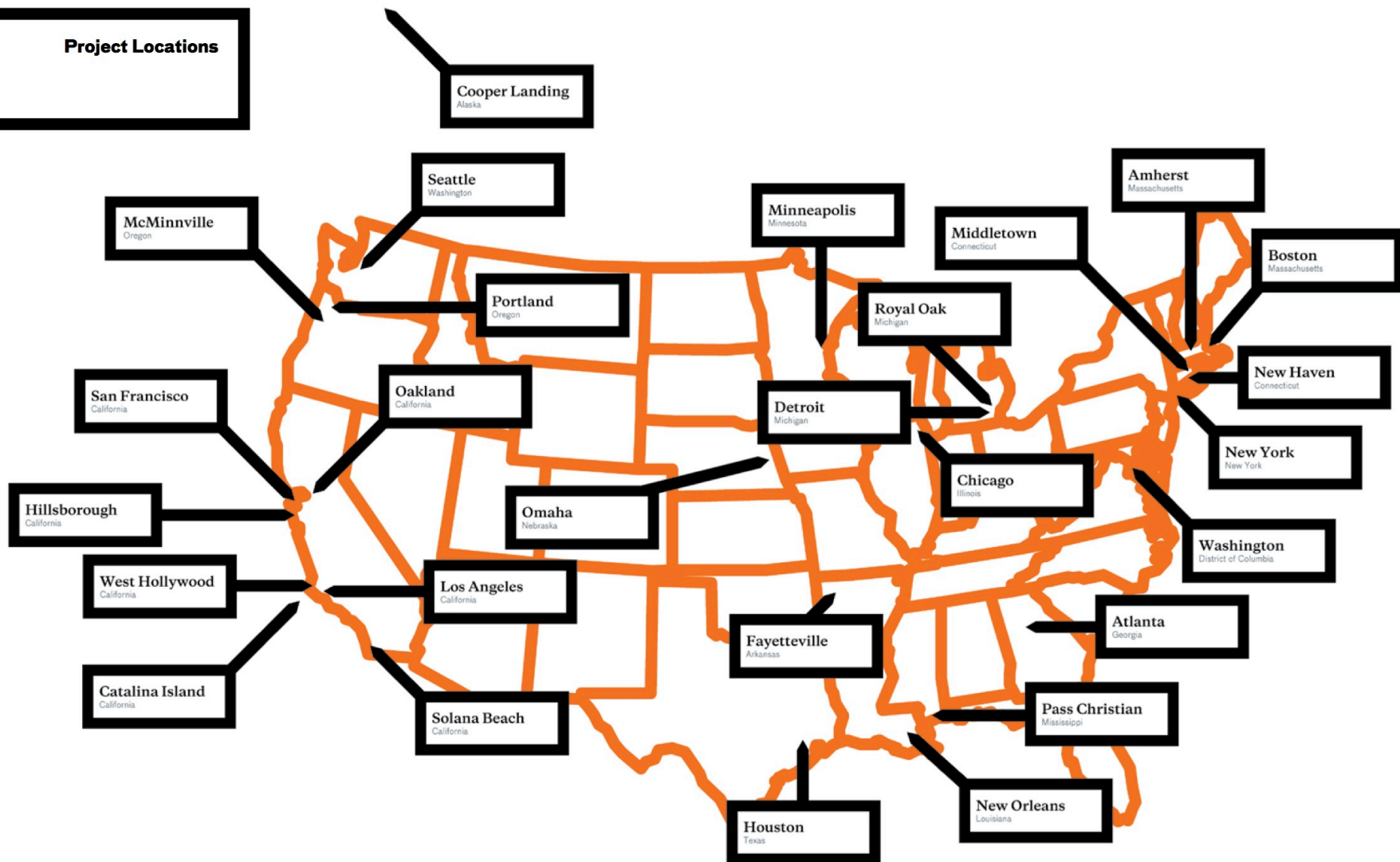

RANDALL OVERLOOK



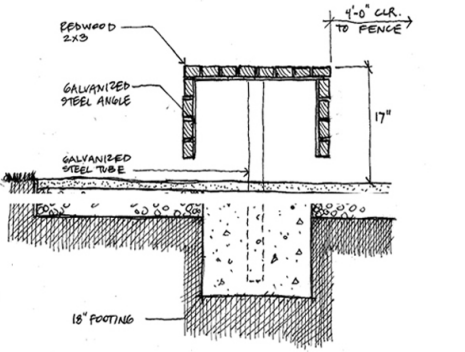
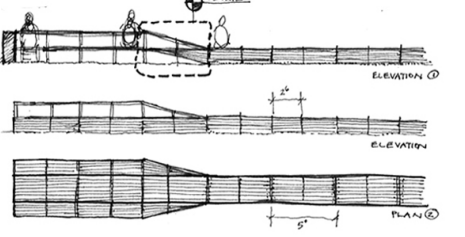
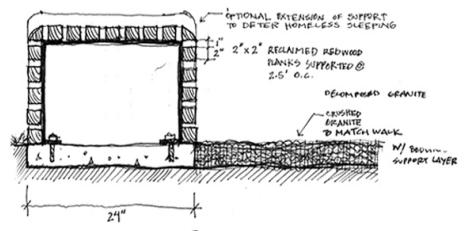
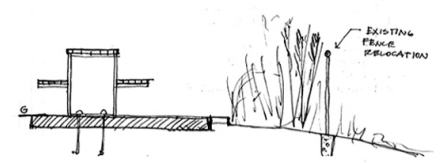
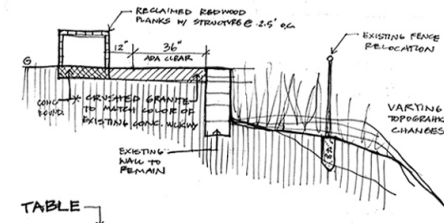
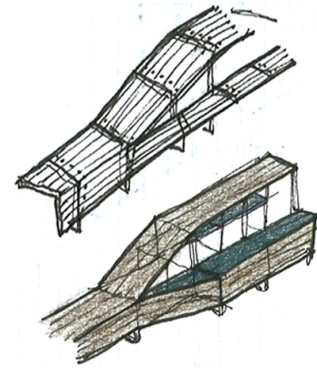
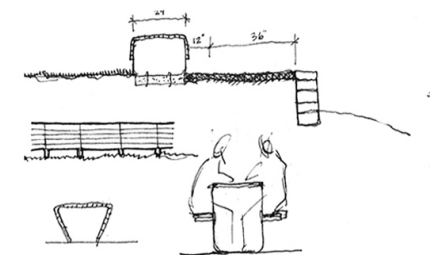
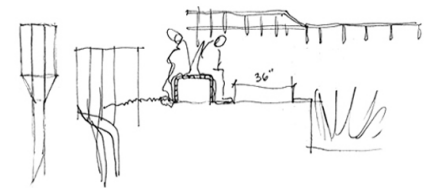
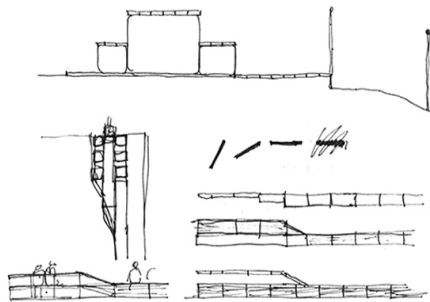

DESIGN CONCEPTS

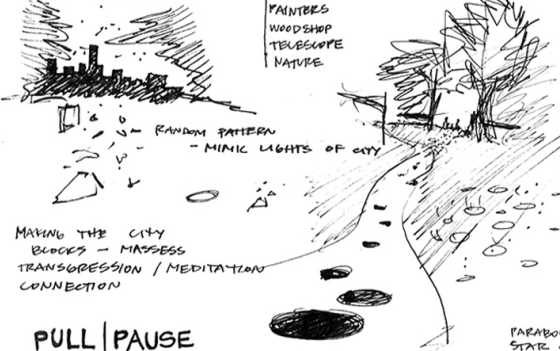

PULL | PAUSE
PAUSE | ROTATE
ROTATE | RELEASE

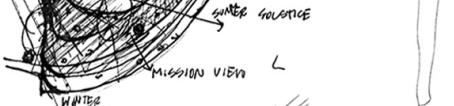
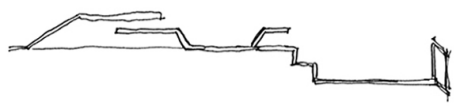

HANDMADE

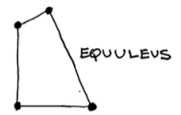

PARABOLIC UMBILIC FOLD
STAR CHART
DIAMOND CURVE
NATURE + MAN MADE BLUE INTO A
SEAMLESS CONTINUITY FORMED FROM
MULTIPLE CONDITIONS... PERCEPTION

SITE FORCES / LINES / PULL
ULTIMATELY WHAT FEELS RIGHT, CALMING



PEACEFUL
STRATA
TEXTURE
COLOR
SUN, WATER, WIND
→ SQUARE LIGHTS
→ DRAINAGE CHANNEL
→ PINWHEELS?

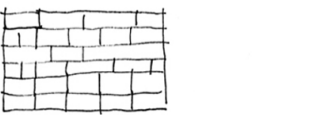

BERPENTINE WALL

STRATA → CURVE W/ SITE
MIMIC GEOLOGY
HILLSIDE CONDITION

WARPED
CURVED
DEFINED BY
SITE



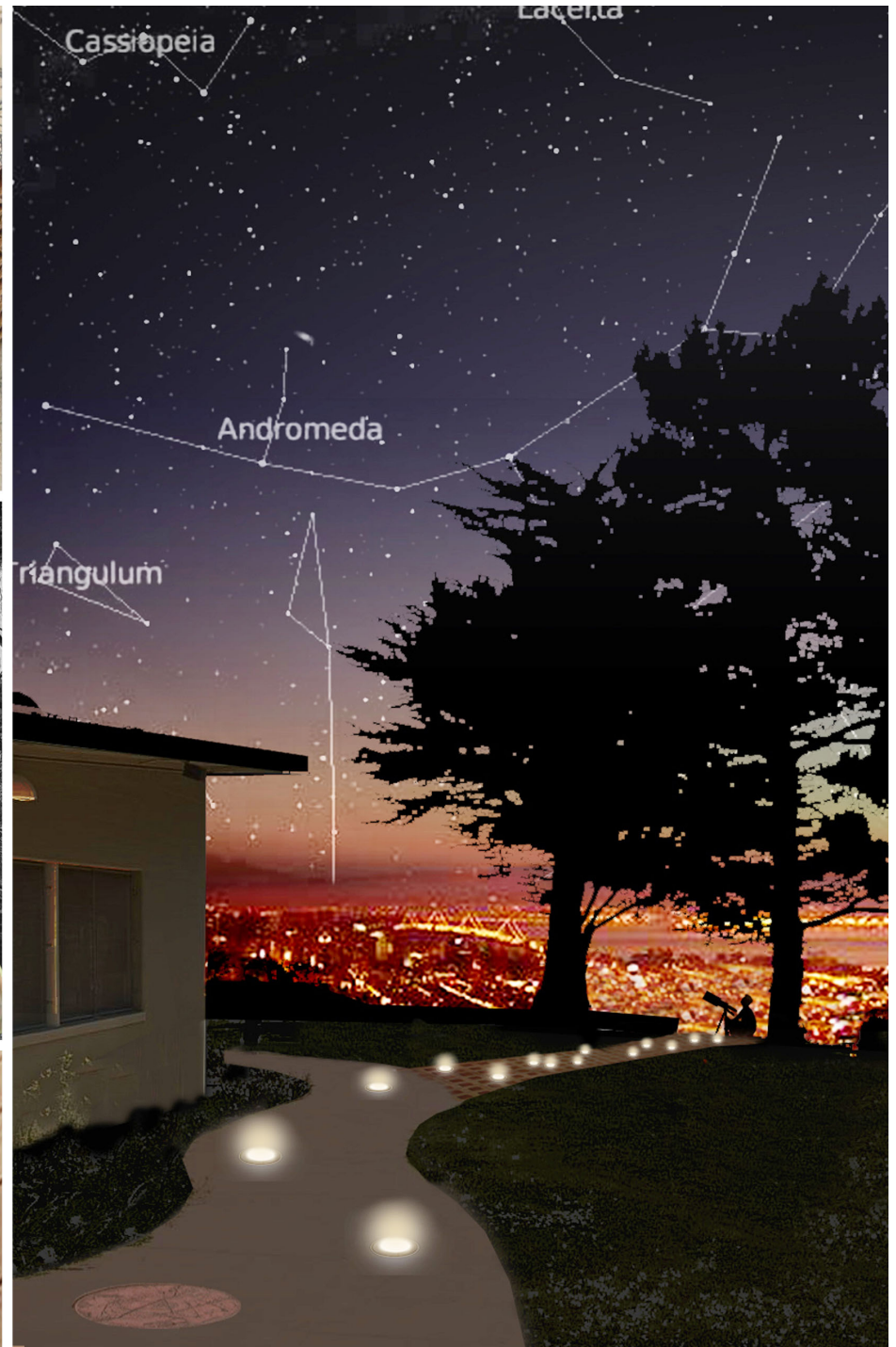
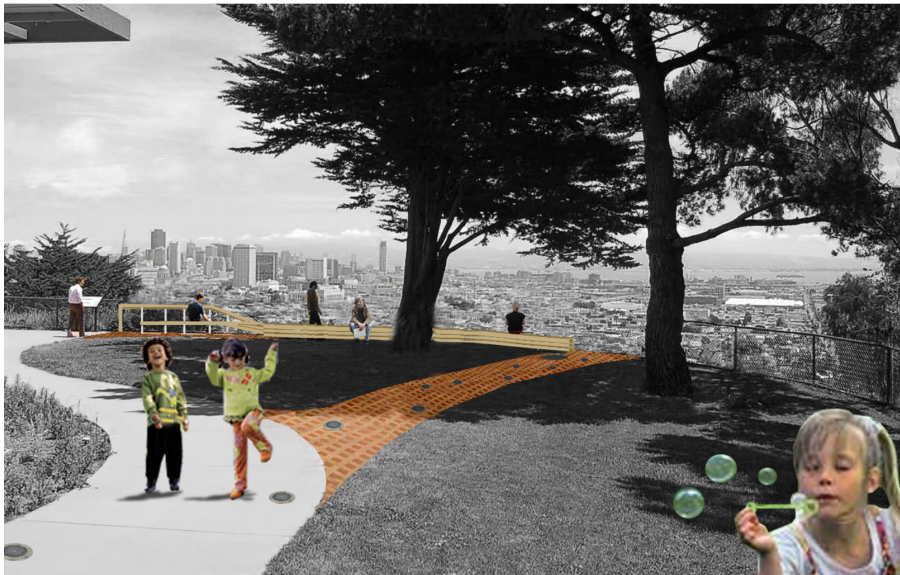
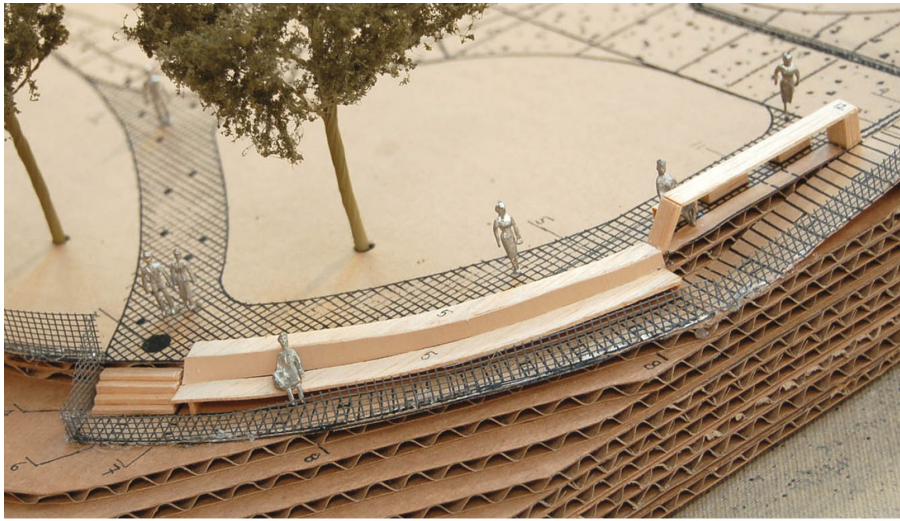



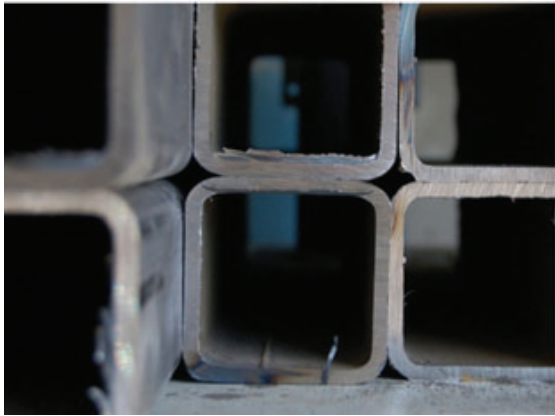
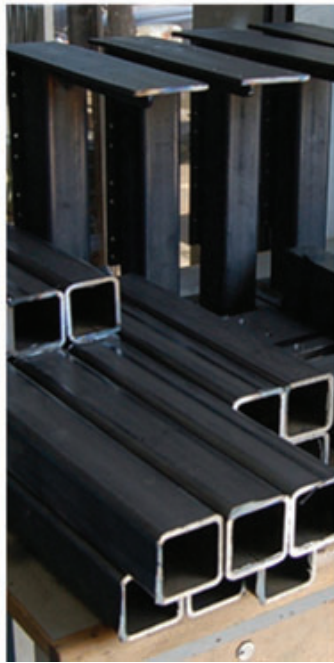











GOLDEN GATE















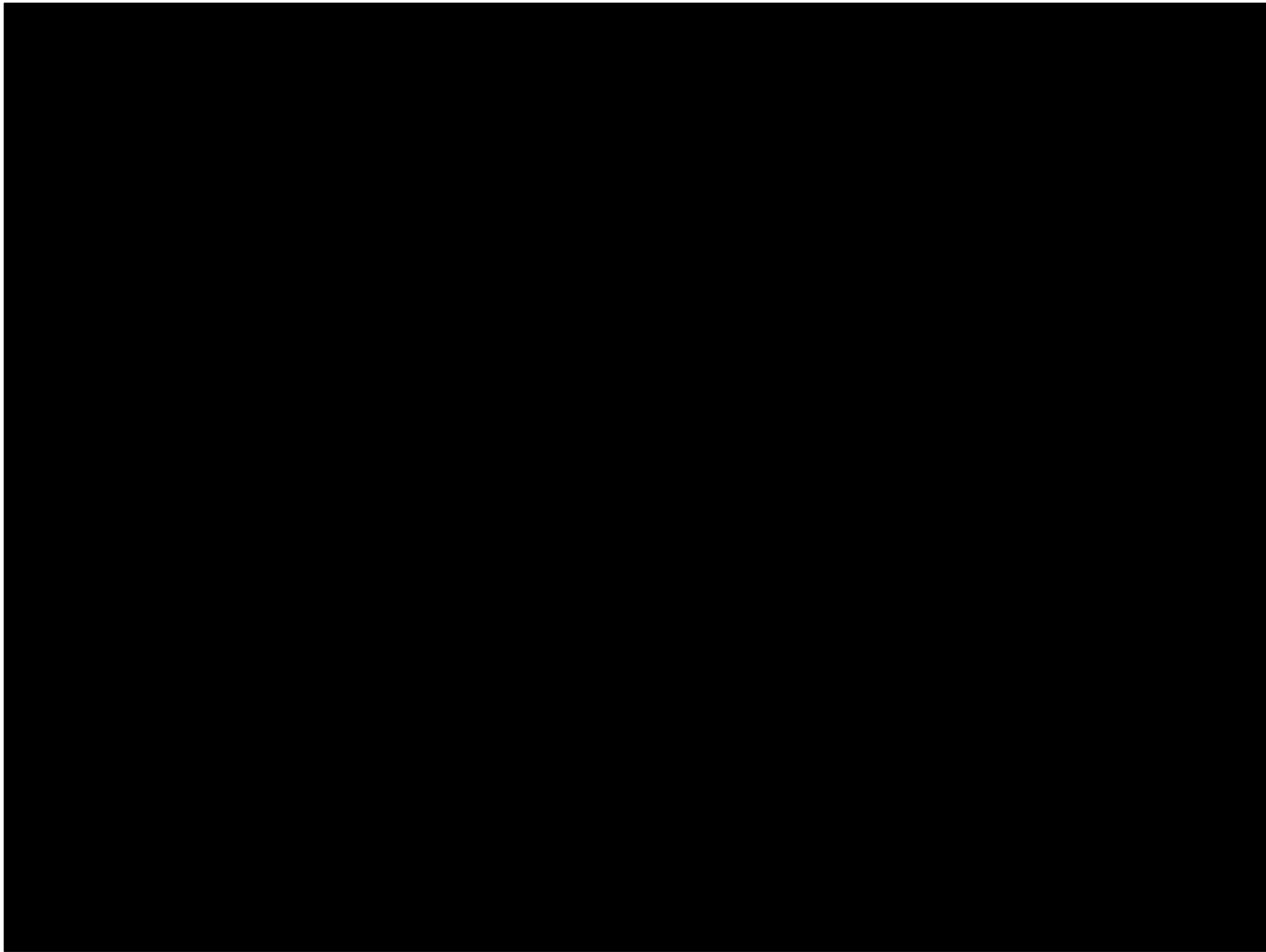

ZHANG JIA YUAN

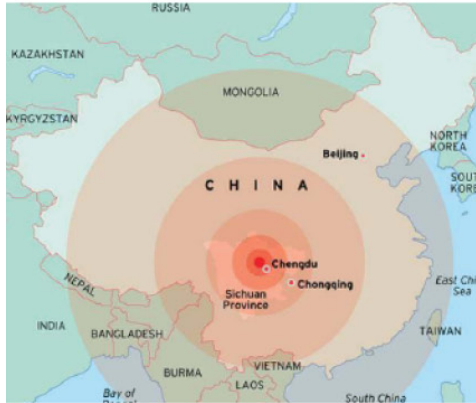

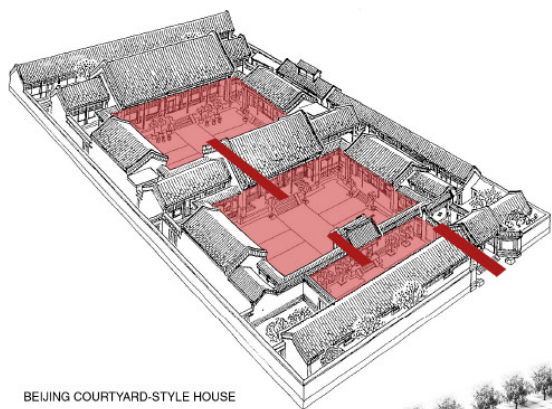

BEIJING COURTYARD-STYLE HOUSE

